

ELMHURST, ILL. SD107.				
Signals	I.C.R.R.	C.G.W.	C.A.E.	Total
Sw. & Derails	6	4	4	14
F.P. Locks	4	4	4	12
	3	1	0	4
Working Levers	13	11	0	24
Spare Levers	4			4
Lever Frame				36

TRACK & SIGNAL PLAN

OFFICE OF GEN. SUPT. TEL. & SIGS.
I.C. SYSTEM
CHICAGO, ILL.

All Functions shown with Levers in Normal Position.
Spare Levers 1-5-27-36
Rocker Shaft Leadout.
Circuits on C.G.W.R.R. as per plan SD107C.
Circuits on I.C.R.R. as per SD 1165-GH.
Circuits on C.A.E. per their Dwg. No. 639.
Electric Lock on 11 & 14 1st Detector Locking.
Electric Locks on 2-6-20-21-23-28-35

Checked: R.C. Anderson
Checked: 2-10-34
Approved: H.A. Morgan
Approved: J.D. Sullivan
Gen. Supt. Tel. & Sigs.
April 27, 1916
June 11, 1920
April 7, 1921
April 26, 1921
May 1, 1922
Jan. 3, 1924
Aug. 11, 1924
November 11, 1929
Mar. 7, 1933
Feb. 2, 1934

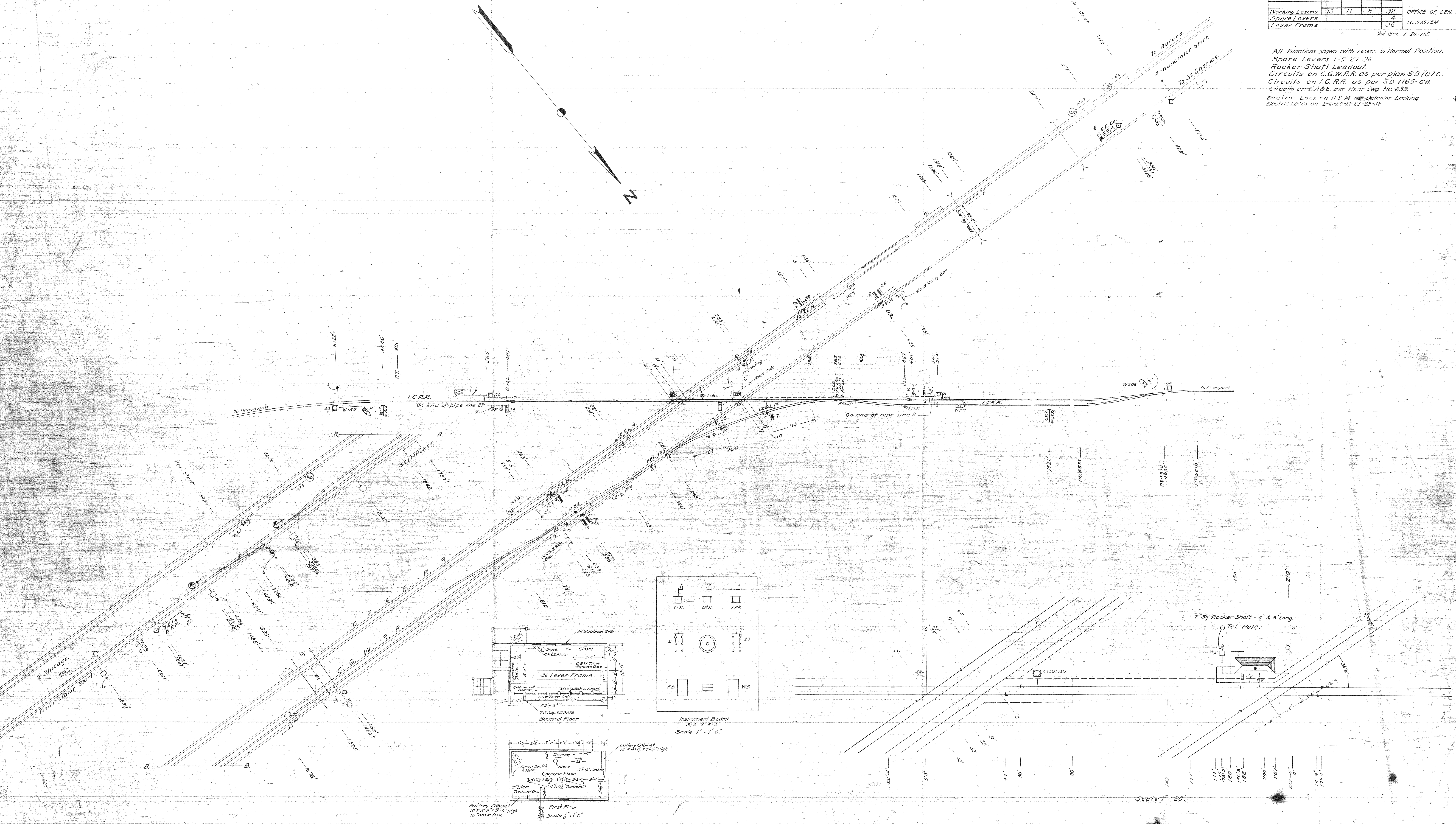

Approved:

R. B. Amaden

H. G. Morgan

N.M. Van der Linde
Gen. Supt. Tel. & Sigs

ELMHURST LOCKING SHEET

SD 107A

Nov. 11, 1929. No Change.
Mar. 7, 1933.
Feb. 2, 1934.

OFFICE OF GEN. SUPT. TEL. & SIGS.
I.C. SYSTEM. CHICAGO, ILL.

SepT 17, 1907.
May 28-1909

Jan. 3, 1924.

April 7, 1921
April 26, 1921

June 27, 1910.
Aug. 26, 1910.
April 27, 1918.

LEVER	WHEN	LOCKS
1	Spare Lever	
2		(8) (11) (18) 23 3 22
3		(8) (11) 7 22 23
	(16) (12)	19-21
4		(10) (11) 22-7
	(12) (16)	19-21
5	Spare Lever	(6)
6		(13) (14) (24) 21
7		(11) (12)
8		(9)
9		10
	12	13-30-31-32-33
	12-16	15-24
10	12	13-30-31-32-33
	12-16	15-24
11	(W10 X (8)) (W12 X (18))	10 (10) 12 (12)
12		
13		16-17
14	24	(15) (W 16 X (13))
15		24
	16	17
16		
17		30-31-32-33-12
	16	24
18		(17)
19		(14) (15) (16) 25
20		(14) (15) (13)
21		(24) (14) 25
	16	(13)
22		(18) (11) 23
23		(16) (11) (8)
24		

25		(14) (16)
	24	(15)
26		(13) (15) (14) 20
27	Spare Lever	(28)
28		(30) (32) 34
29		(31) (33) 35
30		
31		
32		
33		
34		(32) (30)
35		(33) (31)
36	Spare Lever	(35)

April 27, 1918.
April 7, 1921.
April 26, 1921.
Jan. 3, 1924.
Nov. 11, 1929. No Change
Mar. 7, 1933.
Feb. 2, 1934.

Revised per req.
SD107 of May 28 '29
May 28-1909
Revised per requi-
sition of June 27, 1910
Marked prints at-
tached.
June 27, 1910.
Revised per req. of
Aug. 26, 1910. Marked
prints attached.
Aug. 26, 1910.

Checked By
H. A. Lewis
Approved By
J. M. Anderson
Signal Engineer
Sept 17, 1907.
Superseding
SD107B of Apr 19/07

ELMHURST, ILL. SD107B
DOG CHART
OFFICE OF GEN. SUPT. TEL. & SIGS.
I.C. SYSTEM. CHICAGO, ILL.

